

Operation Manual

(GS-401 Powder Machine)

Table Of Contents

Machine View-----	1
Technical Parameters-----	2
Control Box Instructions-----	3
Control Box Assembly-----	3.4
Handle Assembly for Drawer-----	5.6
Operating Instructions-----	6
● Powder Filling-----	6
● Film Position and Adjusting-----	7
● Connecting Power-----	8
● Power Turnning On-----	8
● Shaking On-----	8
● Powder Dropping Control-----	8
● Storage Notes-----	9

Machine View

Trimetric View

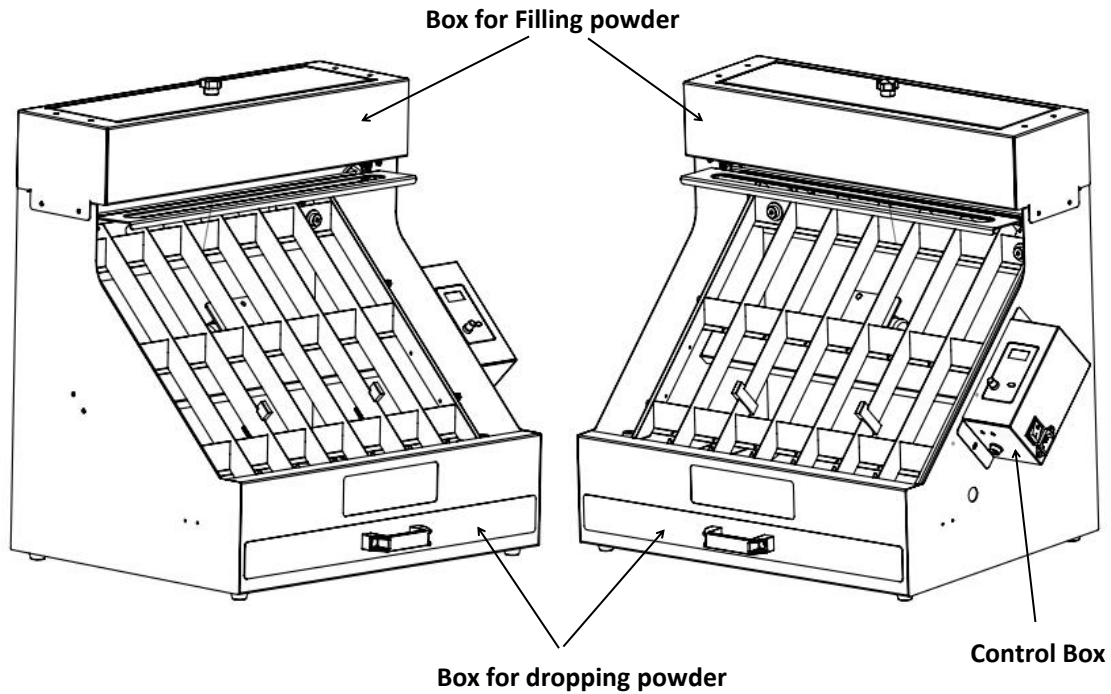

Technical Parameters

Model:	GS-401
Voltage	110V~220V(50/60Hz)
Power	15W
Motor Rotate Speed	0~4500RPM
Powder Volume	4KG
Bigest Film Size	40*50CM
Machine Size:	56.7×43.3×60.7cm(no including control box)
Packing Size:	64.8×50.5×69.5cm
Packing Weight:	27kg
Certificate:	CE,FCC

Control Box Intruccion

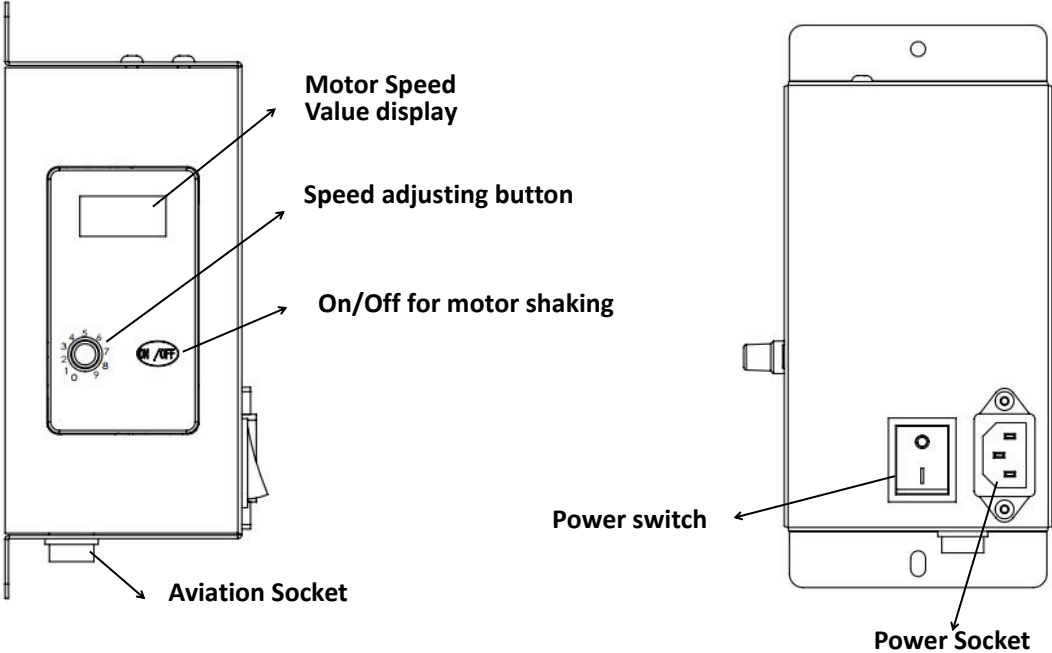

Control Box Assembly

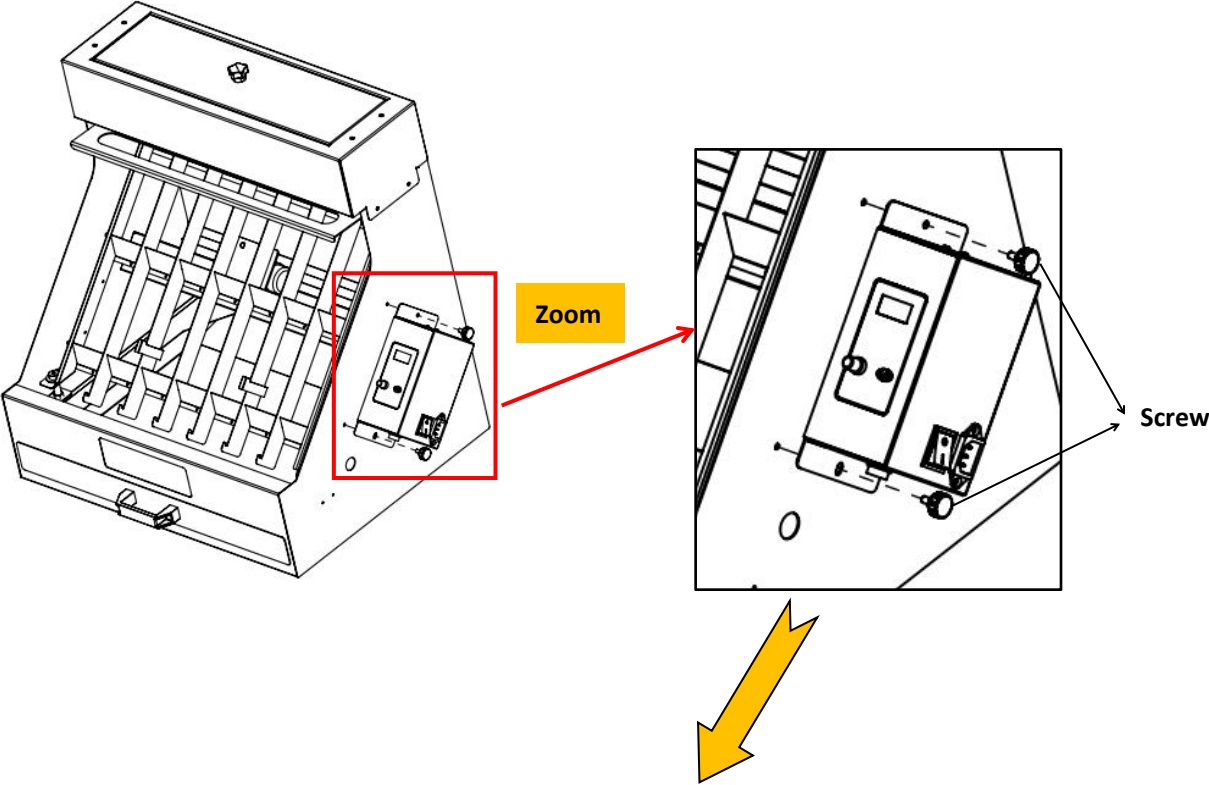

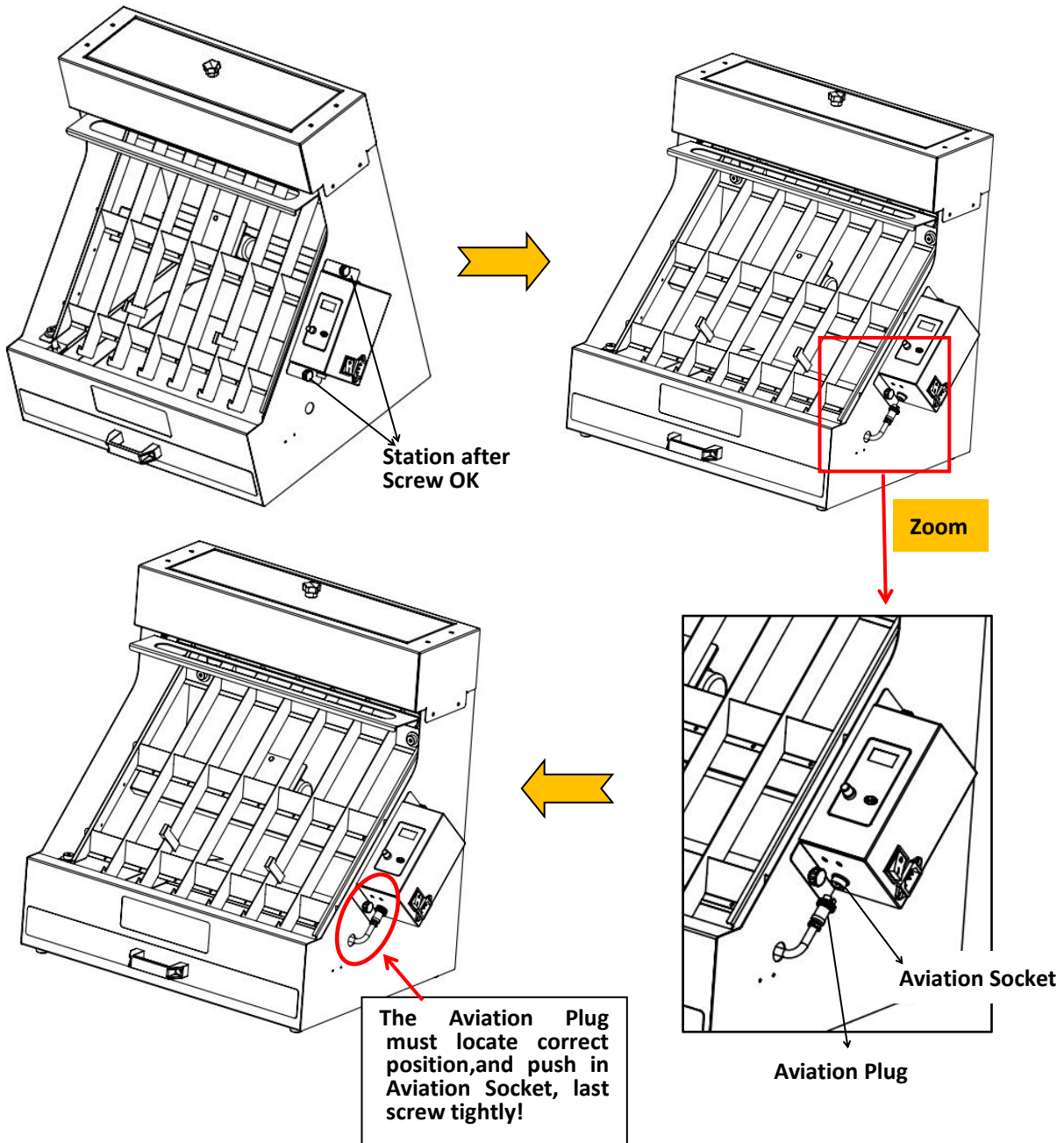

Handle Assembly for Drawer

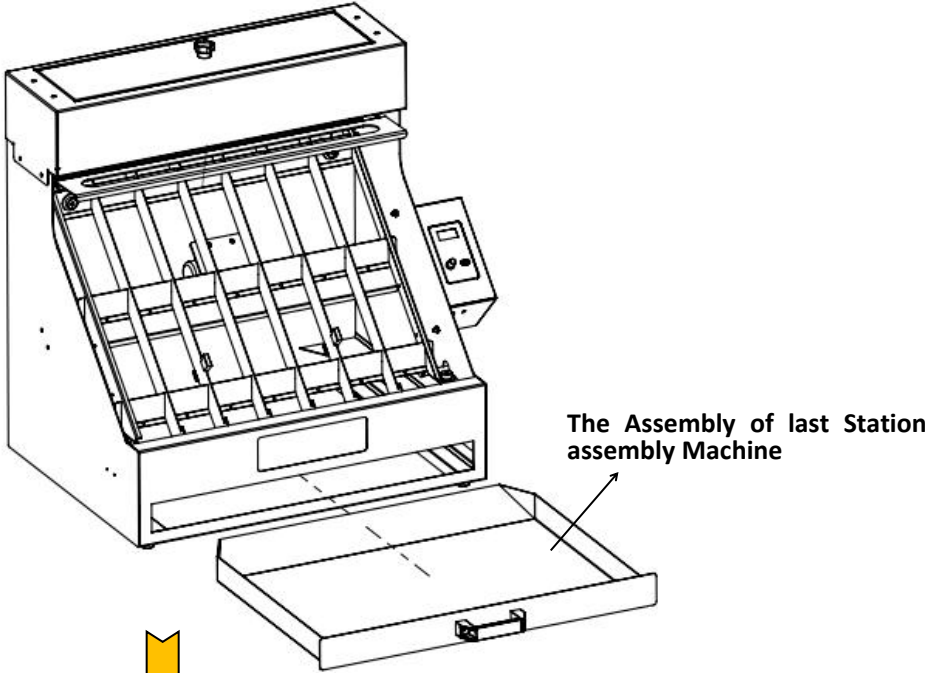
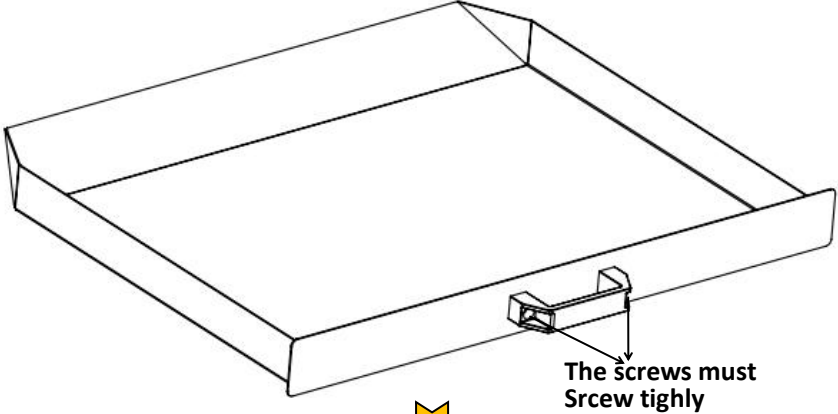
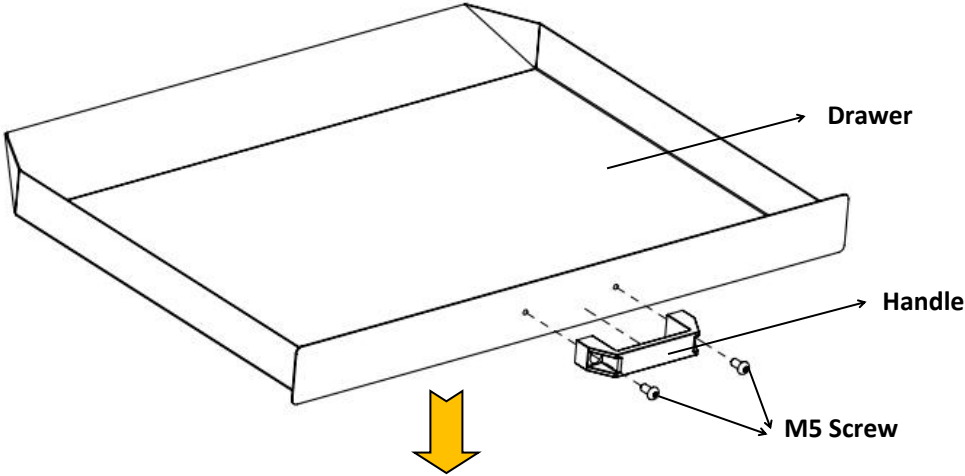

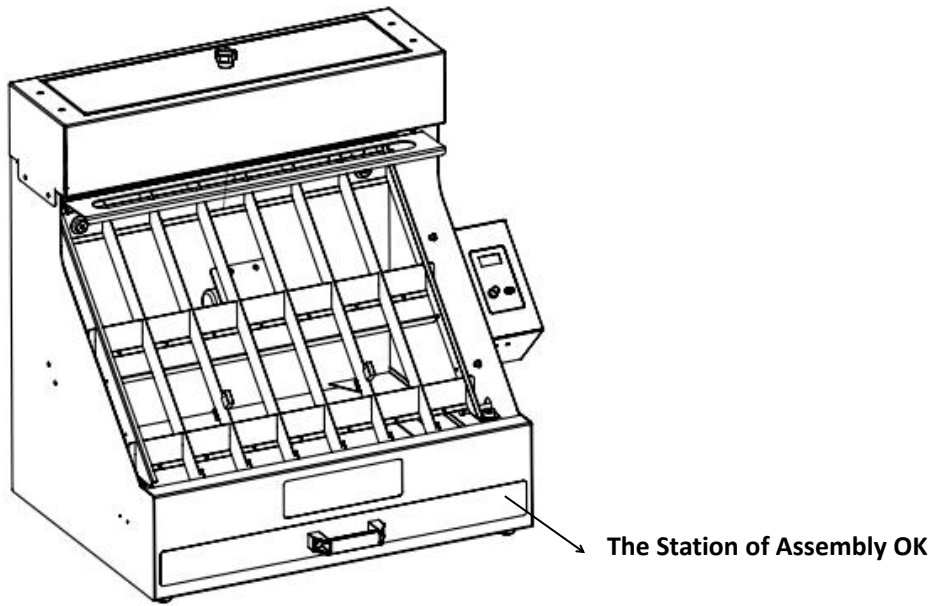

Operation Instructions

1. Powder filling

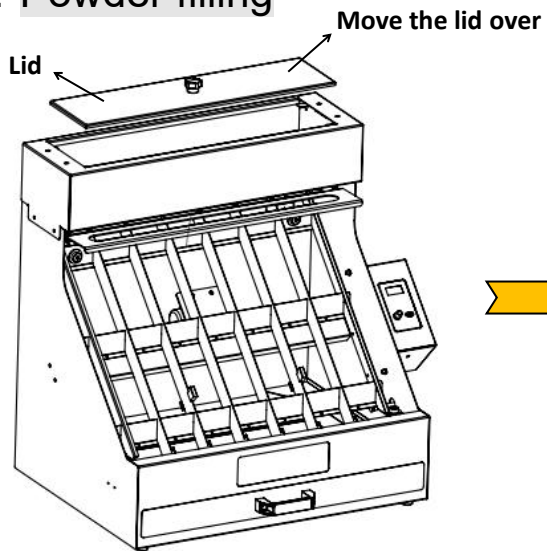

Filling Powder into Box, Bottom of Box is covered even by Powder
Remark: The Box Volume is or so 4Kg

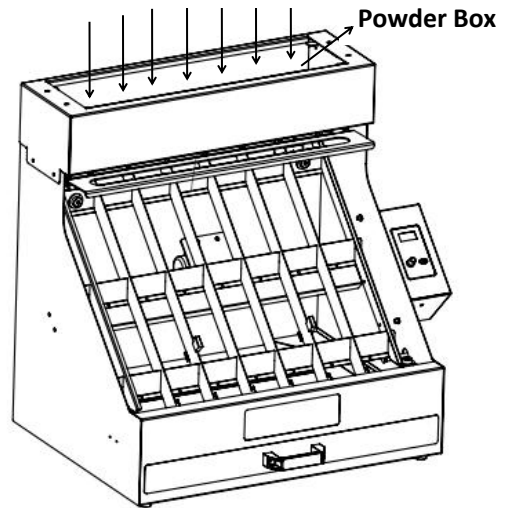

2. Film Position and Adjusting

●.A3 Film Locating

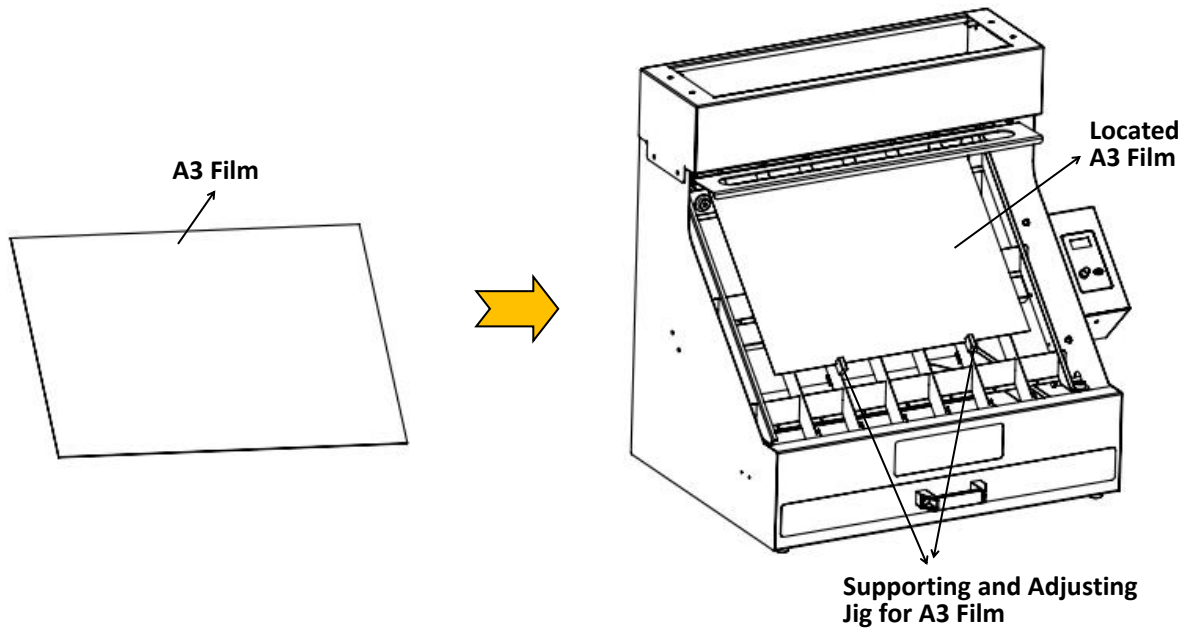

●.40*50CM Film Locating

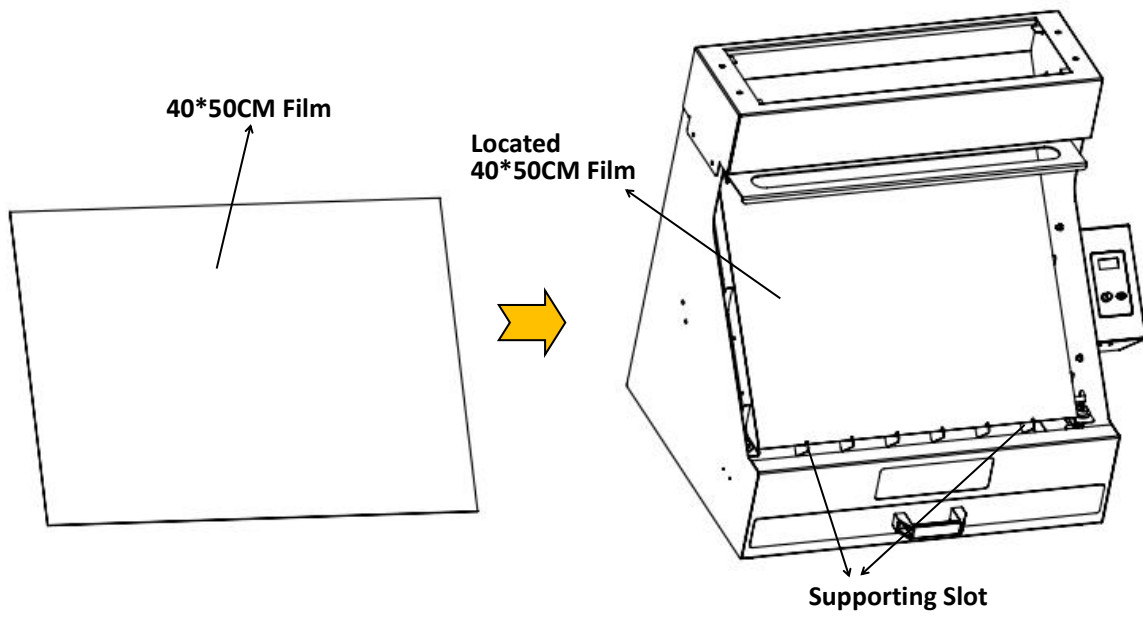

3. Connecting Power

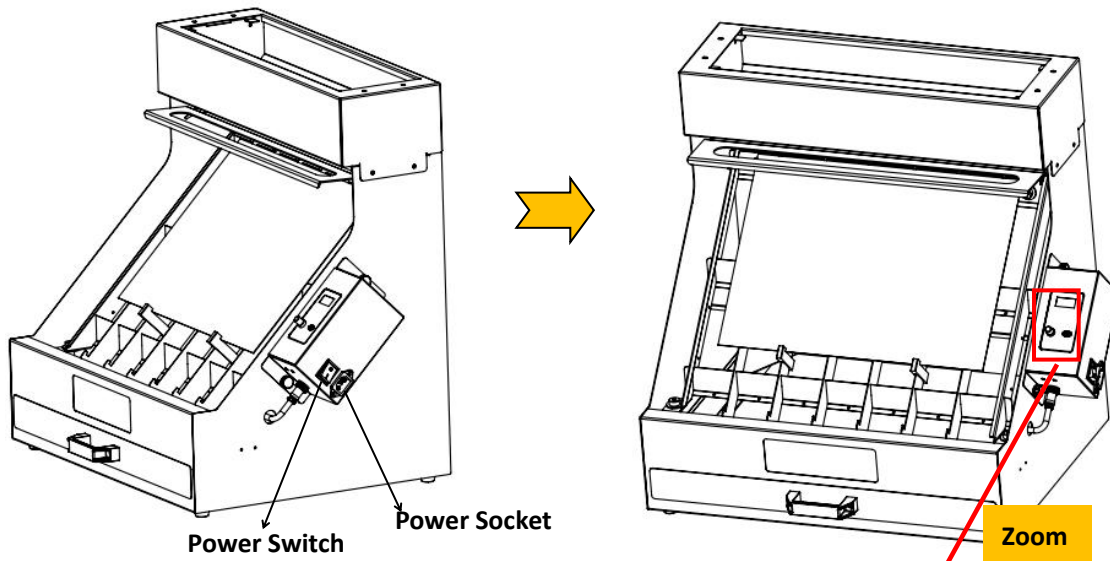

Step Description:
Step 1: Connecting Power, first pushing Power Cord into Power Socket;
Step 2: Turnning On Power Switch, light Representative power is On;
Step 3: Shaking On, Press shaking button and start motor,speed Value display

Remark: Geneally, The speed is adjusted to or so 1500RPM.

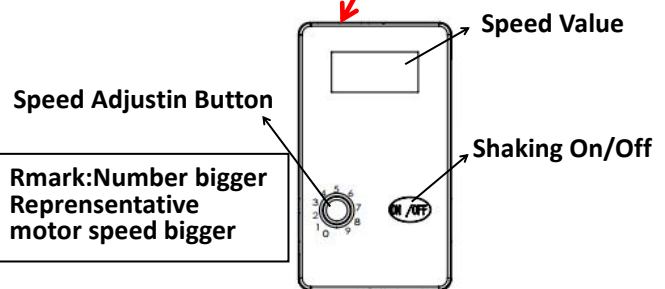

4.Powder Dropping Control

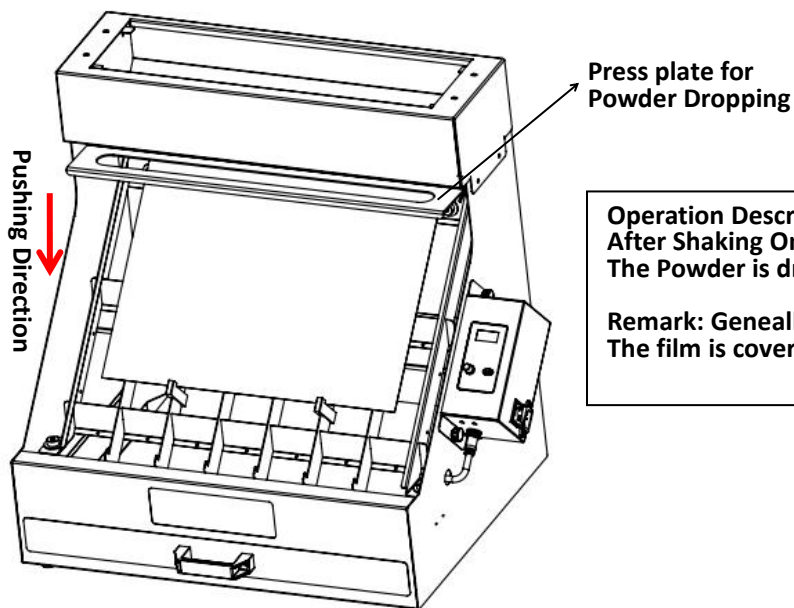

Operation Descreption:
 After Shaking On, Pushing the press plate down, and The Powder is dropping at once.

Remark: Geneally, Pushing the press plate for 3 times, The film is covered by the powder, the Film is OK!

5. Storage Notes

- .Turning off the power Switchafter using, and pull out the Power cord;
- .cover the lid of powder Box,and dress the machine Coat.